

# VELO-SLING

- DE MONTAGEANLEITUNG
- GB ASSEMBLY INSTRUCTIONS
- FR INSTRUCTIONS DE MONTAGE
- IT ISTRUZIONI DI MONTAGGIO
- NL MONTAGE HANDLEIDING
- DK MONTERINGSVEJLEDNING
- ES INSTRUCCIONES DE MONTAJE
- SE MONTERINGS ANVISNING
- NO MONTERINGS ANVISNING
- FI ASENNUSOHJEET
- PL INSTRUKCJA MONTAZU
- JP 装着方法

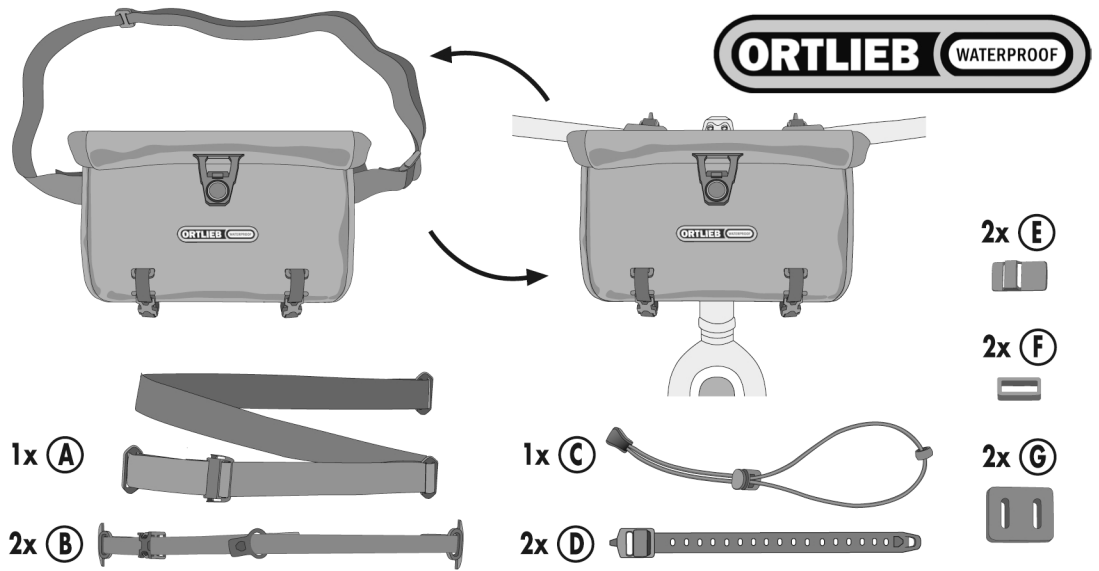

## 1. SLING BAG

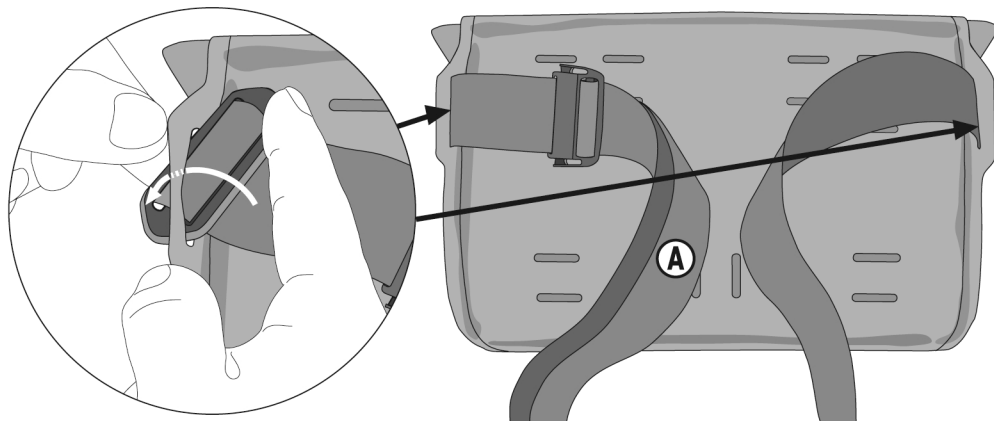

## 2.1 VOLUME EXTENSION STRAPS

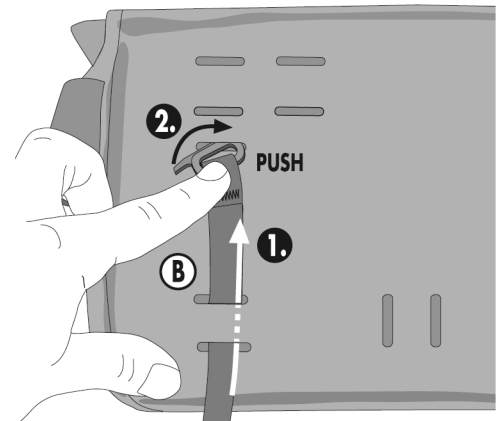

### 2.2

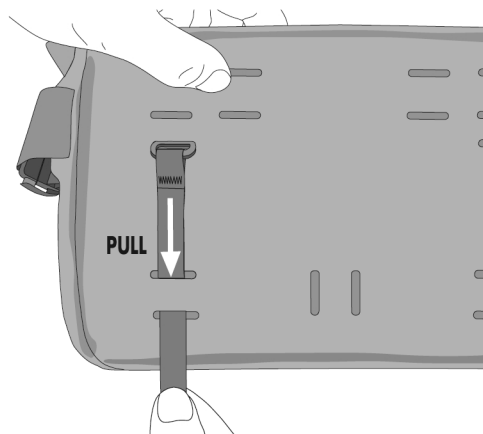

### 2.3

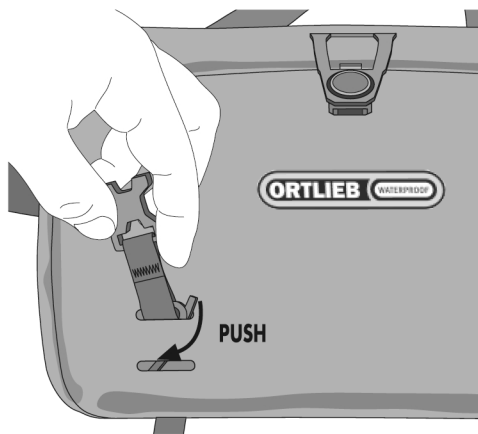

### 2.4

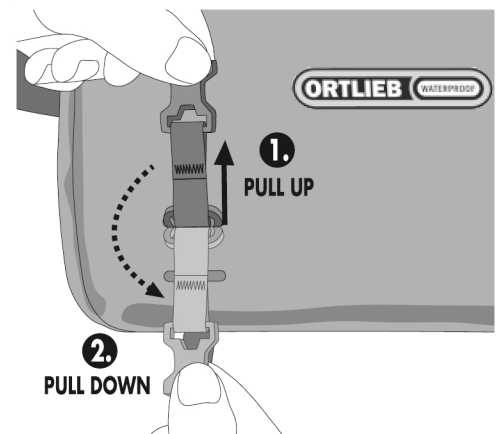

### 2.5

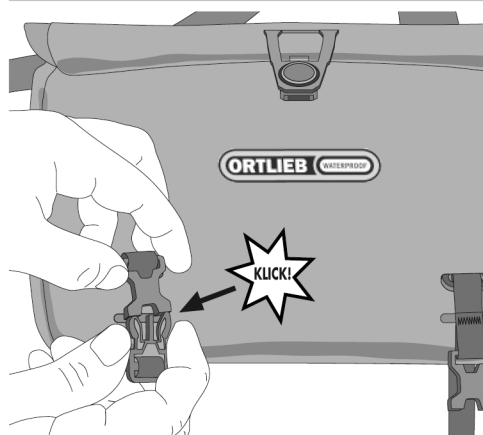

### 2.6

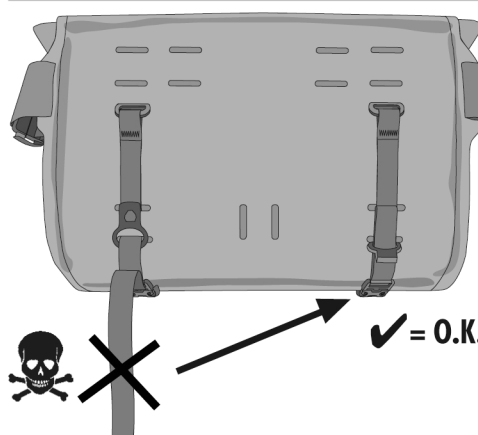

## 3.1 INSTALL HANDLEBAR MOUNTS

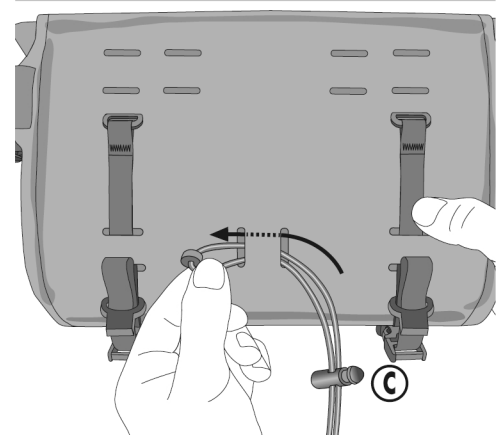

WEITERE INFORMATIONEN:  
MORE INFORMATION:



3.2

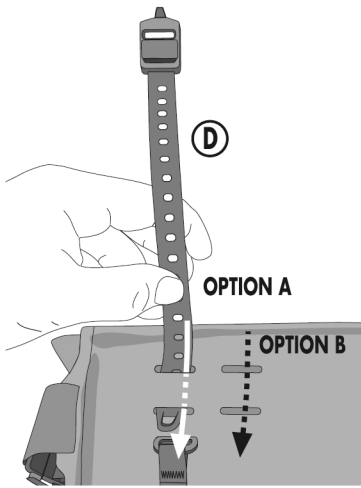

3.3

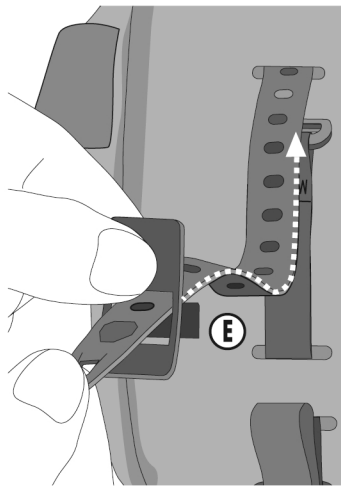

3.4

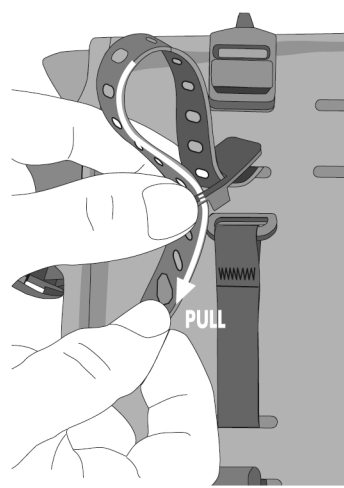

3.5

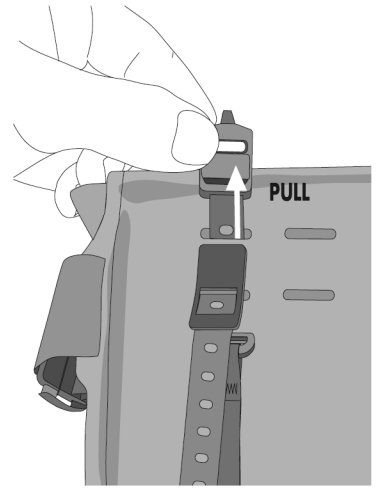

3.6

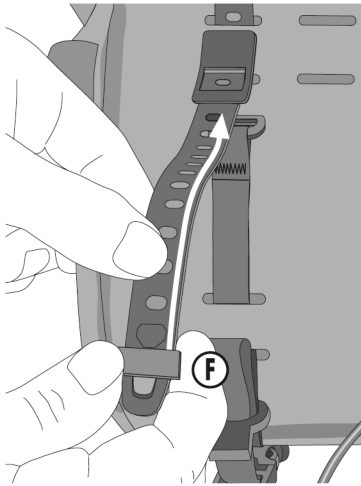

3.7

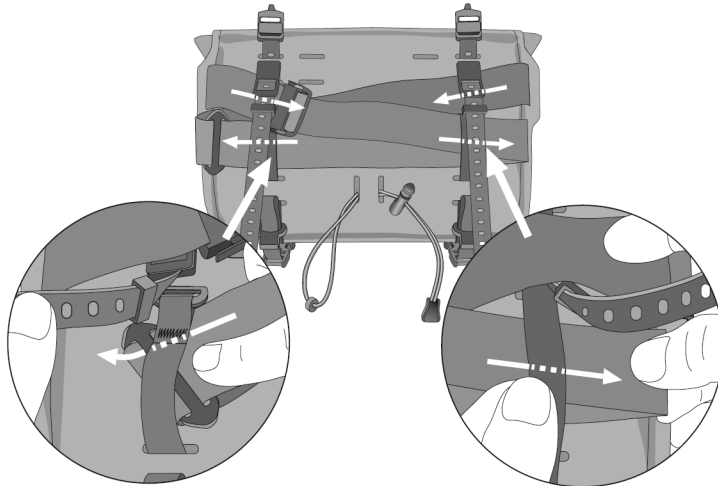

3.8 OPTIONAL

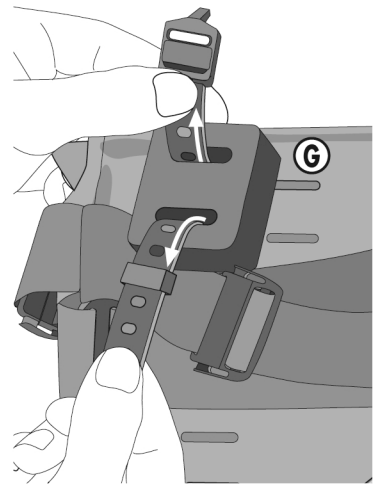

**4.1 HANDLEBAR MOUNTING**

UM ABRIB ZU VERMEIDEN, BENUTZE RAHMENSCHUTZ-FOLIE AN DEN KONTAKTSTELLEN (nicht enthalten)  
TO AVOID ABRASION, USE ADHESIVE FRAME PROTECTION AT CONTACT POINTS (not included)

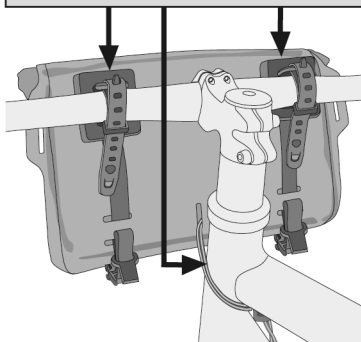

4.2

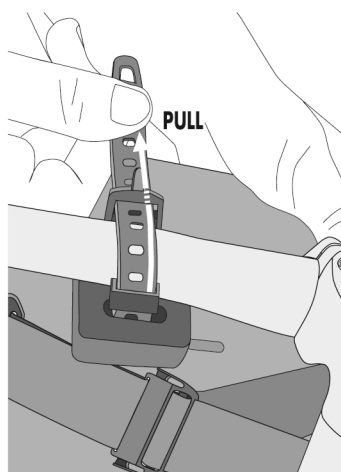

4.3

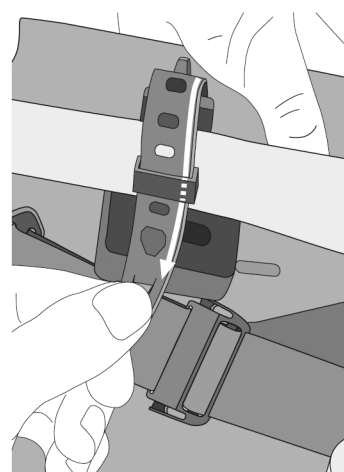

4.4

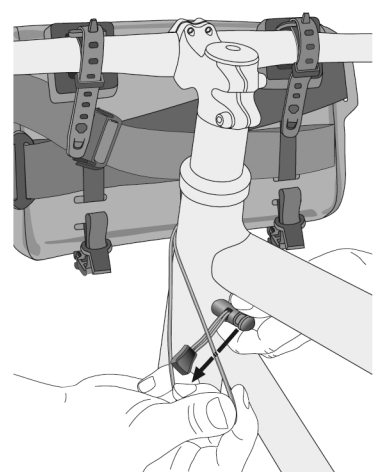

4.5

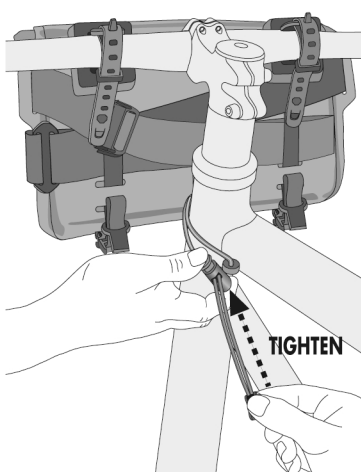

**5. HANDLEBAR BAG**

ENTFERNE DEN SCHULTERGURT FÜR AUSSCHLIESSLICHE NUTZUNG ALS LENKERTASCHE  
REMOVE SHOULDER STRAP FOR SOLE USE AS HANDLEBAR BAG

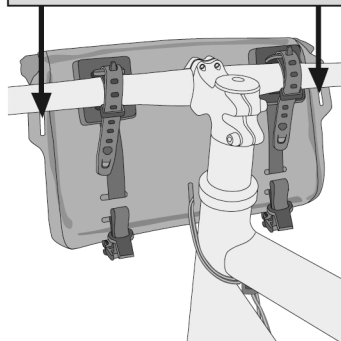

**! CHECK FIXATION AND MAX. LOAD BEFORE EVERY RIDE**

